

# YEAR 7 HANDBOOK 2018-2019

Name:

---

Tutor Group:

---

Tutor:

---

**At St Leonard's everything we do is for the greater glory of God and the good of others.**

**We pursue excellence in all and for all;  
we take Christ as the model for life; and  
we strive to create community.**

Our basic expectations consist of five simple points which sum up the school's expectation of behaviour and attitude at all times:

- (i) be positive; 100% effort in everything you do;
- (ii) be prepared, punctual, properly equipped, homework done;
- (iii) follow instructions first time, every time;
- (iv) show respect; treat others as you would like to be treated;
- (v) look after your school; take care of the school's environment and resources.

**We should always think about what it means to take Christ as the model for life in how we speak, in what we think and in how we act.**

**After reading pages 3 to 5 you should be able to answer the following questions:**

At St Leonard's Catholic School:

<b>QUESTION</b>	<b>WRITE YOUR ANSWER IN THE BOX</b>
1. What do we pursue in all and for all?	
2. Who do we take as our model for life?	
3. What do we strive to create?	
4. Can you list the 5 basic expectations of behaviour and attitude?	
5. Name the three parts of the School Badge.	
6. With what should you wear your uniform?	

# Welcome to St Leonard's

Our school is a Catholic school. We aim to create the right atmosphere for everyone to learn effectively and grow in faith.

As good Christians, we must all aim to be caring and respectful towards others.

We want everyone to prepare themselves well for this life and the life to come.

\*\*\*\*\*

All new pupils are very welcome to St Leonard's.

We hope your years with us will be happy and successful.

This booklet is intended to help you settle in quickly and to give you useful information about the school.

Our rules are not numerous, but they must be followed if all of us, staff and pupils, are to live in harmony.

Remember that you are expected to behave well, be smartly dressed and work hard at all times.

Be thoughtful of others and you will be a credit to yourself, your parents and your new school.

## The School Badge



### THE CROSS

The shape is that of St Cuthbert's cross, whose body lies close to the School, and who is the patron of our Diocese.

### THE CROWNS

You know that we refer to the "Crown of Martyrdom." These crowns remind us of the fact that the School stands on the site where many Catholics died for their Faith in past ages.

### THE CHAIN

The emblem of St Leonard is a chain: old pictures and statues always show him with a chain in his hands.

The badge of St Leonard unites these religious symbols. At your new school we will continue to help you grow as a person through the example of Jesus.

# School Uniform

Your uniform is the outward sign that you are a member of St Leonard's Catholic School. You should wear it with pride. Make sure you wear the correct uniform at all times. Outdoor coats are not to be worn inside the building.

## Boys Years 7-11

- Navy blue school blazer with school badge\*
- Light blue shirt with button at neck.
- Optional navy School Blue V neck jumper (available only from Price & Buckland).
- Dark grey or black school style trousers (no chinos or slim fit trousers)
- School tie.
- Plain black uppers and soles. leather or imitation leather (not suede) sensible school shoes (no trainers, boots, or plimsolls).
- Dark socks.



## Girls Years 7-11

- Navy blue school blazer with school badge\*
- Light blue shirt with button at neck.
- Optional navy School Blue V neck jumper (available only from Price & Buckland).
- Approved navy blue drop waist pleated school style skirt of moderate length or navy blue school style trousers, not lycra or elastane. (Approved items are available from Price & Buckland via the school website.) *Please note that as from September 2015 only one style of school skirt is acceptable as school uniform.*
- School tie.
- Plain black leather or imitation leather sensible school shoes (no trainers, boots, high heels or plimsolls).
- Black tights.
- Black or white ankle or knee socks (no trainer socks or over the knee socks).
- Bare legs or flesh coloured tights are not allowed.

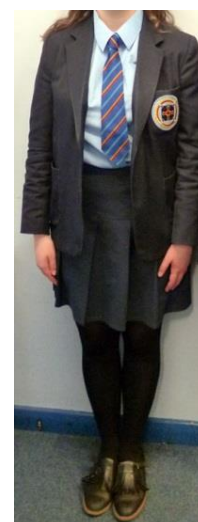

## All Pupils

- Shirts are to be worn tucked into trousers or skirt.
- Blazers should be worn at all times.
- No fashion belts may be worn.
- No body piercings or tattoos.
- All are expected to have a suitable bag to carry books and equipment.

## Jewellery, Make-Up and Hair

- No earrings or jewellery may be worn by any pupil. No other piercings are allowed.
- A wrist watch may be worn.
- No make-up or nail varnish may be worn.
- Pupils are not allowed to have extreme hairstyles or dyed hair which can cause distraction in school.

## **Physical Education Uniform**

The PE uniform is specific to St Leonard's and is available exclusively from **Price & Buckland**. Orders can be placed online via the school website [www.st-leonards.durham.sch.uk](http://www.st-leonards.durham.sch.uk).

Boys	Girls	Compulsory/Optional
Shorts (32303)	Shorts (32303)	Compulsory
Unisex Polo Shirt (6100)	Unisex Polo Shirt (6100)	Compulsory
Reversible Sports Shirt (6400)		Compulsory (Boys only)
Unisex Training Top (6600)	Unisex Training Top (6600)	Optional
Tracksuit Bottoms (6800)	Tracksuit Bottoms (6800)	Optional
Tracksuit Top (6611)	Tracksuit Top (6611)	Optional
	Skort (32315)	Optional (Girls only)
House Socks	House Socks	Compulsory
PE Navy Hoodie	PE Navy Hoodie	Optional

1. Pupils must change into kit, even if they have been excused from the lesson.
2. If pupils cannot take part for medical reasons or do not have the correct kit **A NOTE MUST BE PROVIDED FROM A PARENT OR CARER TO EXPLAIN THE CIRCUMSTANCES.**
3. Before a lesson pupils must ask their teacher if they are allowed to wear tracksuits.
4. It is recommended that pupils wear shin pads for hockey and football, and a mouthguard for rugby (this is optional).
5. If pupils do not have an item of kit a note must be provided to explain. Pupils will then be provided with clean kit to replace missing items.
6. Failure to remember kit will result in the School Behaviour Policy being followed.
7. Watches should be removed for lessons. This applies to all Year Groups including Sixth Form. Doors will be locked during the lessons so valuables will be safe. Alternatively, items may be handed to the teacher for safe keeping.
8. It is essential that you have your name on your kit.

## **Uniform Stockists**

Uniform is available from many retail outlets. Whilst the school does not require parents to purchase all uniform from a particular supplier, the School has entered into partnership with Price & Buckland for the exclusive supply of PE Uniform. Price & Buckland also hold an approved stock of Main School Uniform. All items for sale from Price & Buckland via the school website have been approved as acceptable school uniform. Feedback from parental consultations has informed us that certain aspects of the school uniform most notably appropriate navy blue school skirts and girls' navy blue trousers have been difficult to source. Price and Buckland offer all items of uniform at a reasonable price. Visit our website for details [www.st-leonards.durham.sch.uk](http://www.st-leonards.durham.sch.uk). Other stockists include Uniform, 8 Derwent Street, Sunderland, Tyne and Wear SRI 3NT and Parkins, 71 North Rd, Durham, County Durham DH1 4SQ. Please note that items from Price & Buckland have been approved whereas items from other stockists may vary.

Pupils who fail to wear uniform correctly will be dealt with according to the School's Behaviour Policy.

Parents who experience difficulty in providing the school uniform are asked to contact the school in confidence to discuss the problem.

The Head Teacher's decision on suitable items will be final.

## **School Chaplain**

Our school Chaplain is Miss Catherine Davison. Catherine is in school every day and is always willing to listen to you and help sort out any problems you might have.

## **Wednesday Mass**

Every Wednesday during Period 3 Holy Mass is celebrated in the Chapel. Every Tutor Group has the opportunity to celebrate Mass at least once in the year.

## **EAR 4 U**

Ear 4 U are a team of peer supporters who have been fully trained in basic counselling skills. Younger pupils are able to go to the peer supporters who will listen to their problems and if necessary they will refer the situation to an appropriate member of staff. The peer supporters are available every lunchtime, Monday to Friday.

## **School Nurse**

Our School Nurse is in school by appointment. She is available to discuss a range of health issues, for example:

- diet
- skin problems
- healthy eating.

If you would like an appointment to meet her please see your Head of Year.

## **School Counsellor**

Our school counsellor is Mrs Joanne Lawrence. If you would like an appointment with the counsellor please see your Head of Year. The counsellor can help you with:

- bereavement
- anxiety
- thoughts of self-harm.

## The Pastoral System

	<b>HEADS OF YEAR</b>
Year 7	Miss Blackie (Mrs Bell - September 18 – March 19)
Year 8	Mrs A Grainger
Year 9	Mrs McKelvie (Mr Gray - September 18 – March 19)
Year 10	Mrs S Storey
Year 11	Mr G Johnson
Year 12	Mrs E Alderson
Year 13	Mr Q Hughes

### Head of Year

Your Head of Year is responsible for the welfare of all the pupils in her care. She wants to ensure that you feel secure and happy in St Leonard's and that you are achieving to the best of your ability.

When your parents have to be contacted for any reason then your Head of Year will do this. If your parents have any queries that cannot be dealt with by a note in your planner, they should get in touch with her either by letter or by making an appointment. Your Assistant Head of Year and can also help you with any questions you may have.

<b>Tutor Group</b>	<b>Tutor</b>
7L	Mr S Hastie
7E	Mrs A Stewart
7O	Mrs J Ford
7N	Miss S Brignall
7A	Mr M Thompson
7R	Mr P Sutcliffe
7D	Mrs G Tomlinson/ Miss R Davidson
7S	Mrs A Wright / Miss L Adamson



**After reading page 9 you should be able to answer the following questions:**

Tutors and Procedures:

<b>QUESTION</b>	<b>WRITE YOUR ANSWER IN THE BOX</b>
1. How many times a week will you see your Tutor?	
2. What should you do if you have been absent?	
3. What should you do if you arrive at school after morning registration either because you are late or have been to an appointment?	
4. What should you do if you need to leave school in the middle of the day for an appointment?	

# Tutor

Your Tutor is the teacher you should know best. You will remain with the same Tutor for five years in St Leonard's. You will meet him/her twice every day for registration. During that time, in addition to the register being marked, you will be given information or instructions you need and you will have an opportunity to ask any urgent questions. You will say prayers together every morning as a Tutor Group. On a Wednesday morning you will spend a longer time with your Tutor and during this time you will cover lots of topics in PSHE.

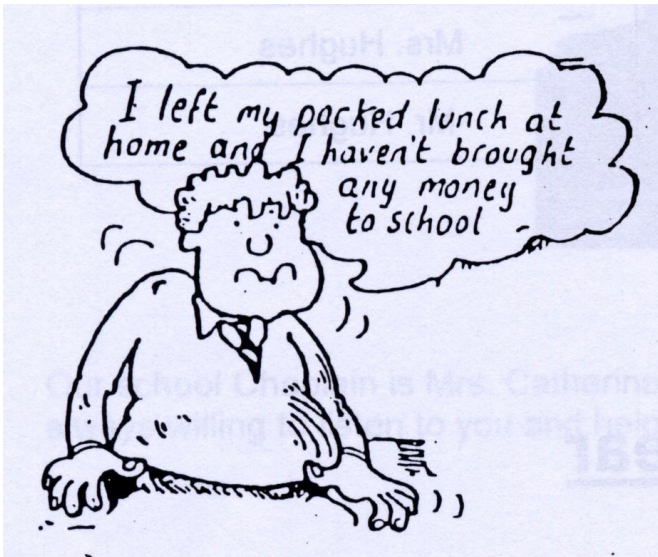

1. Your Tutor must know if you are present or absent. If you come to school late for any reason, you must 'sign in' at the Enquiry Office. Your planner will be stamped with a 'late' mark to inform parents of your late arrival.
2. If you have any questions or worries, ask your Tutor for help and advice. Your Tutor is concerned that you are happy and settled in St Leonard's.
3. Your Tutor will check your uniform daily. You must always wear correct school uniform.
4. After any absence, you must fill in the section of your planner explaining your absence, even if your parents have already contacted us by telephone. You must show this to your Tutor.
5. Your Tutor is keen to see you make progress at school. Each week he/she will check your student planner to see that it is signed up to date and that you are working hard, writing in and completing all homework tasks.

**After reading pages 11 to 12 you should be able to answer the following questions:**

<p>1. Can you list all of the 13 subjects that you will study in Year 7?</p>	
<p>2. What equipment should you have with you every day for lessons?</p>	
<p>3. What does your handbook tell you about recording your homework in your planner?</p>	

## Academic Studies and Progress

HEADS OF DEPARTMENT – Who’s Who	
Art	Mr P Sutcliffe
Design & Technology	Mr M Dunford
English	Mrs B Grehan-Bradley
Geography	Mrs V Stone
History	Mr J Curry
Computing/ Business	Miss L Maughan
Mathematics	Mr N Hamilton
Modern Languages	Mrs H Munro
Music	Mr M Grehan-Bradley
Physical Education	Mrs P Hockaday
Psychology/Sociology	Mrs S Abbiss
Religious Education	Mr N McTernan
Science	Mr N Robertson
Special Needs	Mr M Capper

These teachers are responsible for organising the various subjects on the timetable. They will follow your academic career with great interest and will be constantly checking with your teachers to ensure that you are working to the best of your ability.

Every teacher you meet will treat you with kindness and consideration. Learn their names as soon as possible and address them as “Sir” or “Mr .....” or “Miss” or “Mrs .....”.

During Year 7 you will study Art, Design and Technology, English, French, History, Geography, ICT, Mathematics, Music, PE, RE, Science and PSHE.

## Pupil Planner

On your first day at St Leonard’s you will be given your Student Planner. Write your name and Tutor Group on the front clearly. It is important that you bring it to school every day and have it on your table during every lesson and Tutor time. Your Planner will help you to organise yourself and your work so it is important that you keep it up to date, recording all of your homework and when it has to be handed in. **It is your responsibility** to make sure that your planner is signed every week by your parents and on a prearranged day by your Tutor.

You must keep your planner safe as it contains important information. There are spaces in your Planner where your parents can fill in reasons for your absences, your timetable and homework timetable, places to write key words for subjects and some prayers that you might like.

Your Planner has to last for a whole year, so it must be looked after and not abused. Do not write on it or you will be asked to cover it or buy a new one. There are notes pages for you to write personal information so keep your Planner for school related things such as Parents' Evenings, meetings and deadlines.

## **In order to make Progress**

1. Ensure you are always on time for your lessons.  
Do not delay and waste time when changing lessons.
2. You will need at least two black pens, a green pen, pencil and small ruler (15cm).
3. When homework is given, be certain that you complete it by the required date. Write down the main details of your homework in your planner, the date it is due and tick it off when you have done it.
4. Always listen carefully to your teacher and act upon his/her advice when it is given. If you do not understand part of a lesson, never be afraid to ask. Your teacher will be glad to help. Never interrupt a lesson by impolite behaviour.
5. Really apply yourself to learning: good concentration, best writing, tidy and clean books. Do a little extra work without being instructed to do so!
6. Use the Library, either the School Library or your local branch Library. Don't always read fiction. If you find yourself interested in an item in class, search for a book about it.

**After reading pages 14 to 16 you should be able to answer the following questions:**

<p>1. Which saint was the daughter of the king of Northumbria and what is her House colour?</p>	
<p>2. Which saint's tomb is in Durham Cathedral and what is his House colour?</p>	
<p>3. Which saint's feast day is 25<sup>th</sup> May and what is his House colour?</p>	
<p>4. Which saint was martyred at Dryburn, outside of Durham and what is his House colour?</p>	
<p>6. List 3 ways to get a merit. You will get your first merit by completing all of this holiday homework.</p>	
<p>7. What should mobile 'phones be?</p>	
<p>8. What is expressly forbidden at all times, whether in school, on the school bus or on any school activity?</p>	

## House System

St Leonard's has a House System in school to encourage healthy competition, fun, rivalry and an improved sense of belonging.

Competitions, sporting activities, quizzes etc will be run throughout the year with winners gaining prizes/merits/recognition/rewards for their House.

Each House will have a male and a female House Captain.

### **House Details**

LE – St John Boste's House  
ON – St Hild's House  
AR – St Bede's House  
DS – St Cuthbert's House

### **Head of House**

Mr R Hutchinson  
Mrs S Etherington  
Miss J Smith  
Mr N Dodds

### **ST JOHN BOSTE HOUSE**

Priest and martyr, he studied at Queen's College, Oxford, where in 1569-72 he became a Fellow. He went to Reims, where he was ordained priest, 4 March, 1581, and in April was sent to England. He landed at Hartlepool and became a most zealous missionary. He suffered martyrdom at Dryburn, outside Durham. The House colour is red.

### **ST HILD'S HOUSE**

Benedictine abbess, baptised by St Paulinus. She was the daughter of a king of Northumbria, England, and is considered one of England's greatest women. The House colour is white.

### **ST BEDE'S HOUSE**

Called "the Venerable" to acknowledge his wisdom and learning, the title was formalised at the Council of Aachen in 853. He was a careful scholar and distinguished stylist, the "father" of English history, the first to date events anno domini (AD), and in 1899, was declared the only English doctor of the Church. He died in Wearmouth-Jarrow on May 25. His feast day is May 25. The House colour is blue.

### **ST CUTHBERT'S HOUSE**

St Cuthbert, whose tomb is found in Durham Cathedral, is the patron of our Diocese. St Cuthbert is widely regarded as a great northern saint and a shepherd of his people. The House colour is yellow.

## Merits

Your class teachers will issue up to five merits per class per week.

These are awarded for a range of reasons, including:

- good work
- extra effort
- progress
- enthusiasm
- helping others
- showing respect

Merits are counted weekly and a running total is kept on the main corridor.

## Rewards

Your Head of Year will acknowledge achievement at regular assemblies. Various rewards will be given out for those who achieve merits.

## School Standards

### Care of Buildings and Equipment

- Writing on walls, marking of desks, scribbling on books is absolutely forbidden.
- Felt tip or fibre tip pens are not allowed in school.
- The chewing of gum is permanently and absolutely forbidden.
- No pupil is allowed to carry a pocket knife or any other sharp instrument.

### Litter

- There are wastepaper baskets and litter bins throughout the school. Be sure that you use them for all your litter.



### Lost Property

- This can be handed in or claimed at the Enquiry Office.

### Care of Personal Property

- The care of your property is your responsibility.
- Make sure that all your belongings are clearly labelled.
- No money or valuables are to be left in coats or bags.
- A teacher will always take care of money, watch etc until you require it.
- Do not bring to school any valuable equipment such as i-pods, smart watches.
- Pupils may carry a mobile phone but it should be turned off during the school day and be kept out of sight in a bag or secure pocket. School has a 'Not Seen, Not Heard' policy for mobile phones.

### Mobile 'Phones

If you choose to bring your mobile 'phone to school, you do so at your own risk. If it is lost, damaged or stolen, it will be your responsibility. You do not need to use your mobile 'phone at all during the school day or on the school site.

Mobile 'phones which are brought into school must be turned off (not placed on silent) and stored out of sight as soon as you arrive at the school gate. Your mobile 'phone must remain turned off and out of sight until you have left the school site at the end of the school day. **The simple policy is 'not seen, not heard'**. You should store your mobile phone in your locker. If you need to use your mobile 'phone during the school day or after 3.30pm on the school site, you **must** request the permission of a member of staff, usually your Head of Year. If you use your mobile 'phone without permission during the school day or on the school site, you will be placed on After School Detention.



It is expressly forbidden to record photographic images (still or video) or sound recordings of staff or pupils at any time, whether on the school site, on the school bus or on any school activity. Any pupil caught filming another person (and/or uploading images or video onto the Internet) may have their 'phone confiscated. **It will be treated as a serious disciplinary matter and action taken in accordance with the School's Behaviour Policy.**

### **Travel on Buses**

- Misbehaviour on buses is a very serious offence and will be dealt with severely.
- Remember that the safety of everyone on the bus depends on the driver – let him/her concentrate on his/her job!
- You must always have your **bus pass** if you wish to travel. Any pupil who does not have their bus pass may be charged for the journey or denied travel.

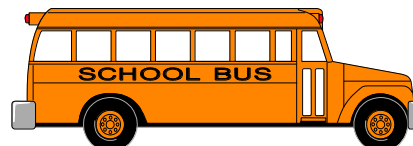

### **Playgrounds**

- The staff car park is permanently out of bounds.
- Football or other games may be played in the yard with a small ball, but is not allowed on the grassed areas.
- You are not allowed on the grassed area in winter.

### **Movement in School**

- Always keep to the left.
- Always move in single file.
- Always walk; never run.
- Never raise your voice.
- Take extra care when using staircases.

### **Attendance**

- You must attend regularly if you are to make progress. The level of expected attendance is 96%.
- Between 8.55am and 3.15pm you must never leave school without permission from your Head of Year. When you need permission to leave school you must bring a note to your Head of Year, or in their absence your deputy Head of Year, who will authorise it and then show your permission slip at the Enquiry Office both when you depart and when you return.
- Always return to school after an appointment if possible – attending half a lesson is better than not at all.
- Holidays are not permitted in term time. In extremely special circumstances, application must be made in writing to the Head Teacher.

### **Punctuality**

- School starts at 8.55am and you should be in the yard by 8.50am.
- Always move smartly from one classroom to another so that you will not miss part of a lesson.

### **Reports to your Parents**

- Your parents will receive a list of progress and effort grades during the year.
- They will also receive an annual report on your progress. Each of your teachers will write a detailed account of your ability and progress in his/her subject. This document will include a pastoral report written by your Tutor. In Year Seven your parents will be invited to come into school to meet with your class teachers.

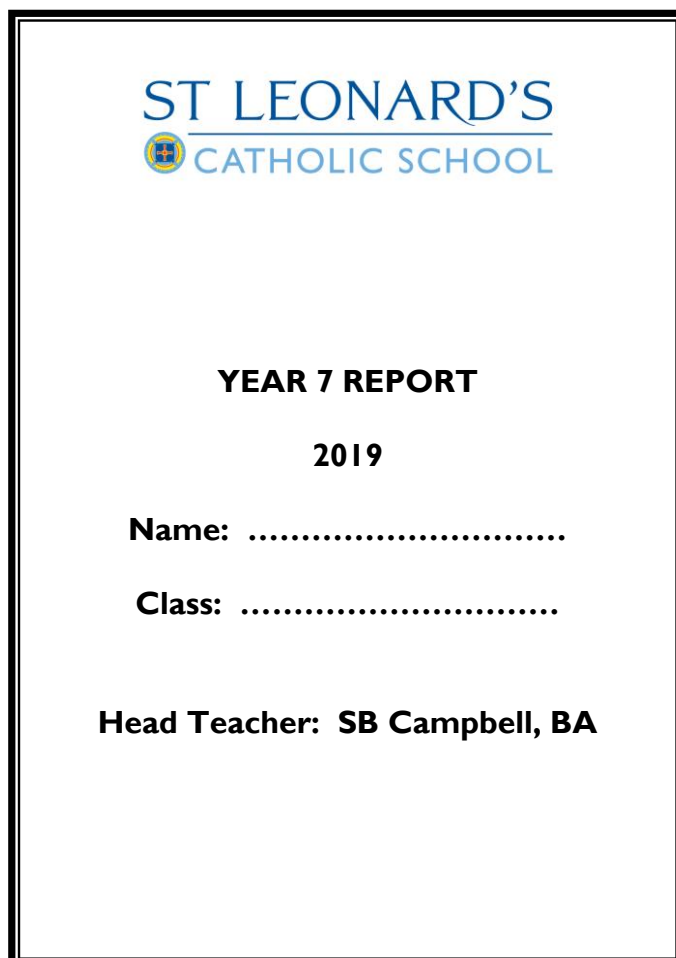

### **What's on the Menu?**

Lunchtime every day is from 12.25pm till 1.05pm except on Wednesday when it is ten minutes later.

#### **DINING AREA**

A Lunch Card system is in operation. You will be given a card in the first week and you will need to put money on to the card. This can be done before school starts or at morning break in the Dining Area. Please keep this card safe. A replacement for a lost or damaged card will cost £2.00.

Those pupils entitled to Free School Meals will have £2.25 per day automatically added to their Lunch Cards.

## **MEALS**

A wide variety of hot and cold food is available for you to choose from.

'Meal Deals' cost £2.25 and offer pasta, sandwiches, traditional lunches etc. Fruit, snacks, drinks and sandwiches are also on offer.

## **BREAKFAST SERVICE**

The Dining Area is open from 8.00am – 8.55am.

Toast, hot drinks and sandwiches are available.

## **BREAK TIME**

You may pick up a sandwich, pizza, toast etc at break time each day.

## **PACKED LUNCHES**

All Year 7 pupils must eat their packed lunches in the Main Hall.

Please keep all these areas clean and tidy. Dispose of all rubbish in the bins provided.

# **Other Information**

## **School Council**

St Leonard's has a School Council made up of representatives of each Tutor Group. It meets regularly and is chaired by the Head Boy and Head Girl. The Council exists to provide a forum where students can discuss issues of concern relating to school life. Once agreed, these issues are brought to the attention of the Head Teacher and Governors. Year 7 pupils will get an opportunity to have a voice on the Council and represent the views of their Tutor Group.

## **Instrumental Music Lessons**

Those pupils receiving instrumental lessons in primary schools (strings, woodwind, brass, guitar) will automatically continue at St Leonard's. Lessons are timetabled to minimise disruption to the school timetable. Pupils above grade 1 standard are expected to join the School Orchestra and attend weekly lunchtime rehearsals. Any pupils wishing to discontinue lessons should inform the Kingsway Music Centre as soon as possible.

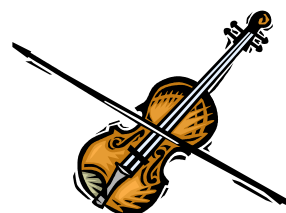

(Some upper floors have been moved for clarity)

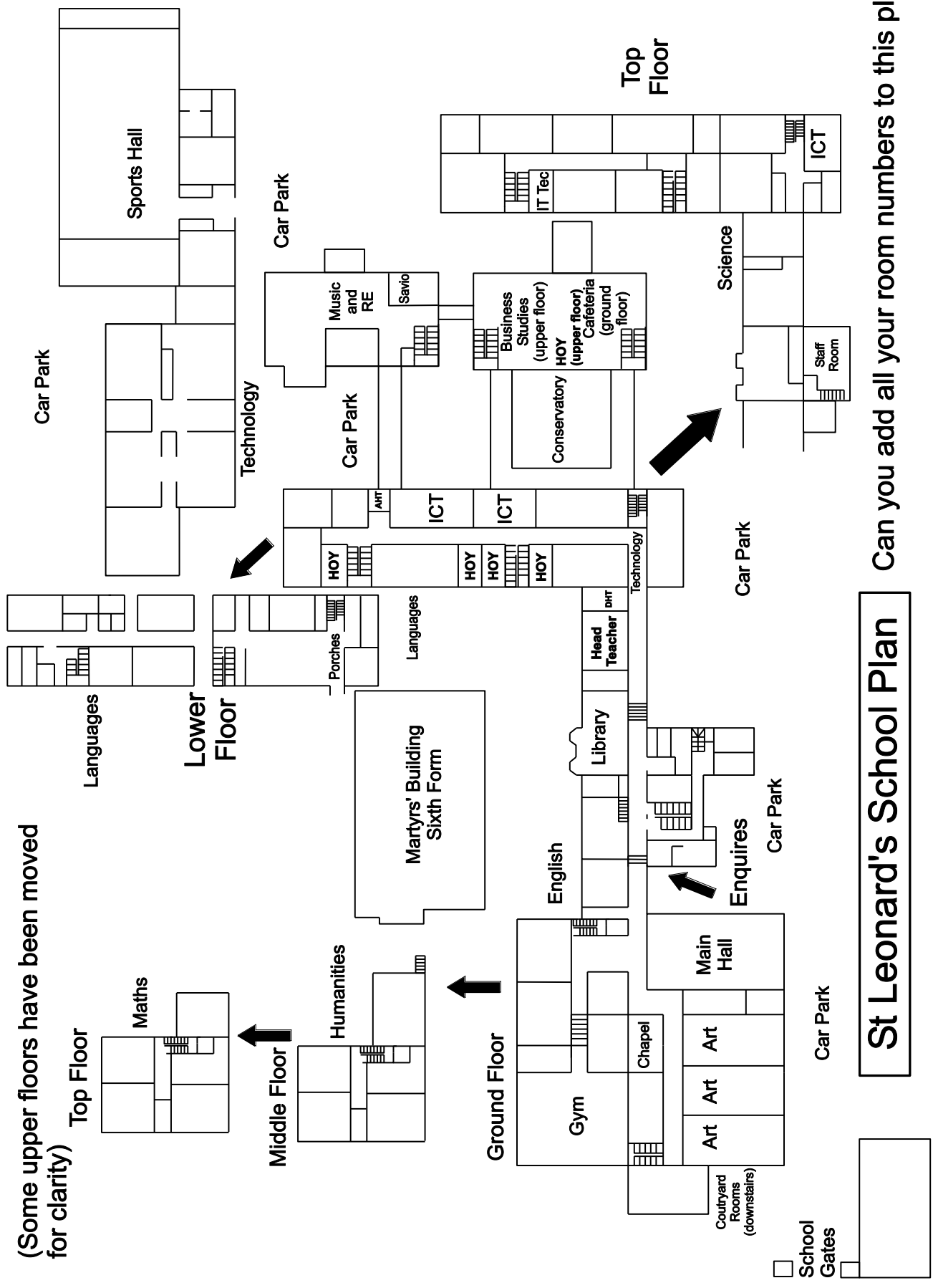

# St Leonard's School Plan

Can you add all your room numbers to this plan?



## Clubs

Why not join a lunchtime or out of school club and make new friends? You will probably thoroughly enjoy it. Here are a few, but keep your eyes open for posters on notice boards around school.

<b>ACTIVITY</b>	<b>DAY</b>	<b>TIME</b>	<b>PLACE</b>
Public Speaking	Autumn Term	To be arranged	See Mrs Grehan-Bradley
Poetry Writing Competition	Autumn Term	To be arranged	See Mrs Grehan-Bradley
Football	To be arranged	To be arranged	See PE staff
Netball	To be arranged	To be arranged	See PE staff
Girls' Football	To be arranged	To be arranged	See PE staff
Running /Fitness	To be arranged	To be arranged	See PE staff
Badminton	To be arranged	To be arranged	See PE staff
Rowing	To be arranged	To be arranged	See Mr Smith
Table Tennis	To be arranged	To be arranged	See PE staff
Cricket	To be arranged	To be arranged	See PE staff
Climbing	To be arranged	To be arranged	See PE staff
Lower School Orchestra	Wednesday	3.15 – 4.00pm	Main Hall
Lower School Choir	Monday	12.45pm	Music Room 2
Drum Club	Wednesday	12.55 – 1.15pm	Recording Studio
Senior Choir	Tuesday	3.15 – 4.45pm	Music Room 1
Senior Orchestra	Thursday	3.15 – 4.30pm	Main Hall
Music Homework Club/ Keyboard Club	Thursday	12.30 – 1.00pm	Music Room 2
Carnegie Reading Group	Wednesday – Summer Term	12.25 – 12.50pm	Mr McConnell
STEM	Tuesday	3.15 -4.30pm	Dt10 – see Mr Routledge
Art Club	Tuesday	3.15 – 4.15pm	Art Club
Garden Club	Monday	3.15 – 4.30pm	Library – see Mrs Duggan
EAR4U	Monday + Thursday	12.25pm	En2 – see Mrs Lawrence
Check Mates	Tuesday	3.30 – 4.30pm	La3 – see Mrs Lawrence
Homework Club	Tuesday, Wednesday + Thursday  Wednesday + Friday	3.30 – 4.30pm   12.25 – 1.05pm	Library   Dt1

# Holiday Dates



**2018 – 2019**

<b>Holiday</b>	<b>Closing Date</b>	<b>Re-Open</b>
Summer 2018	Friday 20.7.18	Wednesday 5.9.18
Autumn Half Term 2018	Friday 19.10.18	Monday 29.10.18
Christmas 2018	Thursday 20.12.18* (differs from LA)	Tuesday 8.1.19
Spring Half Term 2019	Friday 15.2.19	Monday 25.2.19
Easter 2019 * (differs from LA)	Friday 12.4.19	Monday 29.4.19
May Day Bank Holiday 2019	Friday 3.5.19	Tuesday 7.5.19
Summer Half Term 2019	Friday 24.5.19	Monday 3.6.19
Summer 2019	Friday 19.7.19	To be determined

## St Leonard's Catholic School Wordsearch

W R F I L P Q Y M E S D F A T O T I L Y E O H L L  
 P W M B E A R T V V T G L C I V Z D J X P J Z W Z  
 E O H N S E H I B E J P Z Q H H J L C F V J X H D  
 V C C I S P T N L N O P U P P T R E B H T U C T S  
 V I N P T I S U U O H L E N O T L H L A S M C G B  
 L E E A S E A M E T N N C P C L S S T H I L D E R  
 S C K O D Z E M X H B I Z H E T E S E D R F S W P  
 T H P F O N O O Q E O S Q N A D U W O N H B Z U W  
 W O L L E Y E C Z A S N C T I I E A A R C W B Q X  
 S F G C I D J T K R T E E R U Y N P L R C C Y I U  
 P R E P A R E D T D E E P E E P A S R U L E R Y B  
 A J C L T B U E H A J F J D S R N H Q L R C M R K  
 R Y F Q N S G Z P F O T E I J T G K M X A R J O D  
 O H W V W M H Y U M L B H U M I O B K Z D O A T O  
 X M S M J T H V F V T J Y F D A D N T J H W L U V  
 C I A M K C C M B S G N S X I M K L Z Y A N S T C  
 Z B M N V I N X L M K R R E N N A L P I N S G J O  
 Y Z K Y V S P P H F N S H A R R N N D B N E G L H

ATTENDANCE  
 BLUE  
 CHAINS  
 CHRIST  
 COMMUNITY  
 CROSS  
 CROWNS  
 EXCELLENCE  
 NOT HEARD

NOT SEEN  
 PEN  
 PENCIL  
 PLANNER  
 POSITIVE  
 PREPARED  
 PRIDE  
 PUNCTUAL  
 RED

RESPECT  
 RULER  
 ST BEDE  
 ST CUTHBERT  
 ST HILD  
 ST JOHN BOSTE  
 TUTOR  
 WHITE  
 YELLOW

# OUR EXPECTATIONS



be positive,  
100% effort in  
everything you do



be punctual,  
properly equipped,  
homework done



follow instructions,  
first time, every time

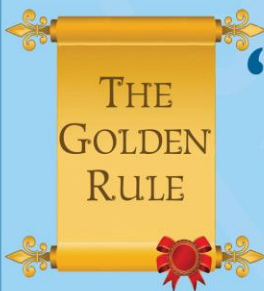

“Treat other people as you  
would like to be treated.”

(Matthew 7:12)



look after your school,  
take care of the school's  
environment and resources